

All dimensions to be checked on site. Figured dimensions take preference over scaled dimensions. Any errors or discrepancies to be reported to the Architects. This drawing may not be edited or modified by the recipient.

Copyright and ownership of this drawing is vested in RKD Architects, whose prior written consent is required for its use, reproduction or for publication to any third party. All rights reserved by the law of copyright and by international copyright conventions are reserved to RKD Architects and may be protected by court proceedings for damages and/or injunctions and costs.

RKD Architects' Quality Management Systems are certified to ISO 9001:2015.

- USES**
- 1B2P Apartment
 - 2B3P Apartment
 - 2B4P Apartment

NOTE: Refer to drawing series A1500 for detail unit plans, internal room dimensions and areas.

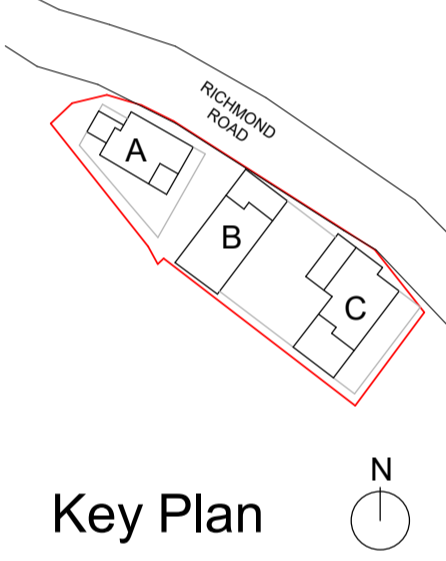
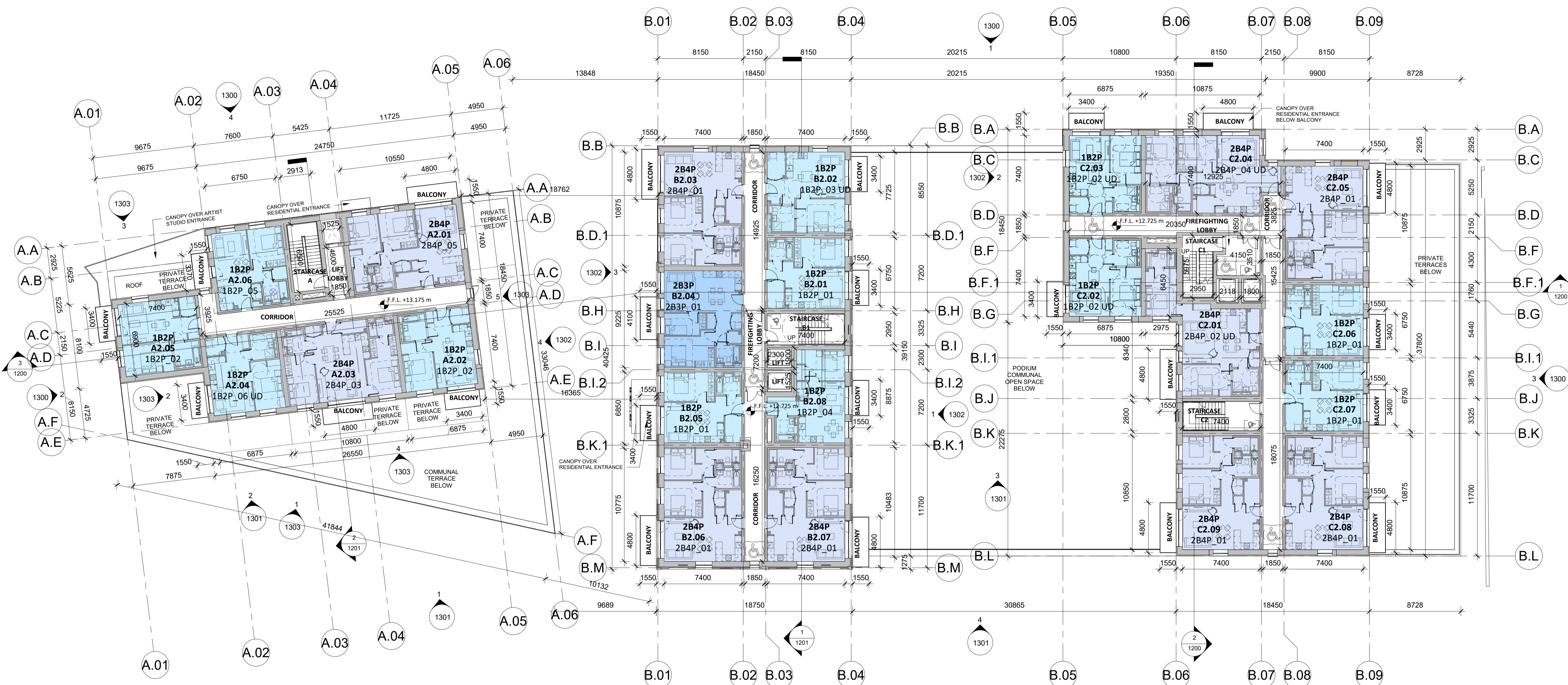

1 1102_ Second Floor Plan - GA
1 : 200

Second Floor GFA Schedule				
Block	Level	Name	GFA	USE
BLOCK A	Level 02 - Second Floor	CIRCULATION	59.0 m2	RESIDENTIAL
BLOCK A	Level 02 - Second Floor	CORE	43.0 m2	RESIDENTIAL
BLOCK A	Level 02 - Second Floor	RESIDENTIAL	379.5 m2	RESIDENTIAL
TOTAL			481.5 m2	
BLOCK B	Level 02 - Second Floor	CIRCULATION	83.6 m2	RESIDENTIAL
BLOCK B	Level 02 - Second Floor	CORE	41.0 m2	RESIDENTIAL
BLOCK B	Level 02 - Second Floor	RESIDENTIAL	549.4 m2	RESIDENTIAL
TOTAL			674.1 m2	
BLOCK C	Level 02 - Second Floor	CIRCULATION	107.0 m2	RESIDENTIAL
BLOCK C	Level 02 - Second Floor	CORE	80.1 m2	RESIDENTIAL
BLOCK C	Level 02 - Second Floor	RESIDENTIAL	652.0 m2	RESIDENTIAL
TOTAL			839.1 m2	
TOTAL			1,994.7 m2	

PS 27/01/2023 ISSUED FOR PLANNING
 P4 13/01/2023 ISSUED FOR PRE-PLANNING
 P3 08/10/2022 ISSUED FOR PRE-PLANNING
 P2 09/09/2022 ISSUED FOR PRE-PLANNING
 P1 25/08/2022 ISSUED FOR PRE-PLANNING

Rev.	Date	Description

MALKEY LIMITED

STATUS **PLANNING**

PROJECT **158A RICHMOND ROAD**

PROJECT ADDRESS **158A RICHMOND ROAD DUBLIN 3**

DWG TITLE **SECOND FLOOR PLAN - GENERAL ARRANGEMENT**

DWG NO. **22001-RKD-ZZ-02-DR-A-1102**

REV.	STATUS	PROJECT NO.
P5	A3	22001

DATE **JAN 2023** DRN **JB** CHK **HB**

RKD

59 Northumberland Rd
 Ballsbridge, Dublin 4
 D04 W9P6, Ireland

+353 1 666 1055
 mail@rkd.ie
 rkd.ie